

**PRODUCT DESCRIPTION**

- Fixed output build in LED Driver.
- Constant Current LED Driver.
- Nominal Life-Time Upto 50,000 hr.
- 3/5-Years Warranty.
- High Voltage withstanding capacity 250V AC.
- CE ( Certified ).
- IS 15885 ( Part 2/Sec 13).
- IS 16104.
- IEC 60950-1.
- IEC 61000-4-5.

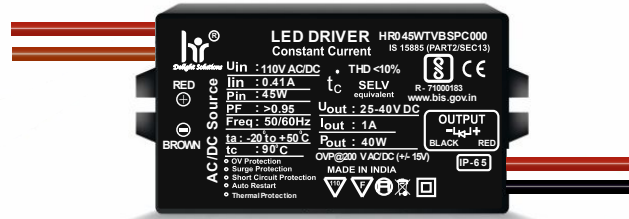

Input Characteristics			Mechanical Details		
1	Rated Voltage With AC/DC	110V	1	Weight	150gm
2	Operating Voltage Range (AC/DC)	90-156V	2	Case Dimensions	
3	Frequency (Hz)	50 / 60	3	Length W/Mount	101mm
4	Maximum Input Current	0.33A		Center to Center (CTC)	87mm
5	Input Power (W)	36W		Width	46mm
6	Power Factor (PF)	>0.95		Height	30mm
7	Current Harmonics (Athd)	<10	4	Case Material	PC
8	Over Voltage Cut off For DC	200-205V	5	Wiring Diagram	On Screen
9	Automatic Restart ± 20V For DC	195V	6	Input / Output Terminals	Wire
10	Lower Cut Off ± 20V For DC	60V	7	Wires Length	
11	Driver Life	>50000		Input (3 Core or single core- White(L,N) & Green-E)	300mm
12	Surge Withstand Capacity	4KV		Output ( Single Core Wire- Red(+),Black(-)	300mm
			8	Potting	Yes IP-65/67

Output Characteristics			Key Features		
1	Output short circuit protection and Restart	Yes	1	Compact Design	
2	Thermal Protection	Yes	2	High Voltage Withstand 250V DC/AC for 2 Minutes.	
3	No-Load Protection	Yes	3	High Surge withstanding capacity	
4	Max Output Current	800MA (Tole : +/-3%)	4	Long Life	
5	Output Voltage	25-40V	5	High Durability	
6	Output Power (W)	32W max	6	Automatic Restart after Safe Voltage Mode.	
7	Efficiency	>85%			

Environmental Operating Details			Plastic Box		
1	Minimum Starting Temperature	-30°C ... 75°C			
2	Max. Ambient Temperature	-20°C ... to 65°C			
3	Max. Case temperature (Tc)	75°C			

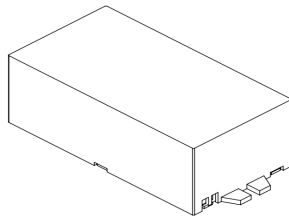

Bottom			Top		
